

NOTES:

1. Metal Edge Flashing, Wood Blockings and Attachments shall comply with ANSI/SPRI ES-1
2. Refer to SMACNA recommendations and details regarding metal thickness and cleat requirements. Continuous cleats are recommended at all edges and coping flashings, cleats to be at least one gauge heavier than the edge/coping metal.
3. Wood blocking may be slotted for venting of wet-fill decks or other applicable constructions.
4. For heat fused membrane applications, set metal flashing onto heated softened membrane.
5. Extension of field base/plies 1" min above top of cant, required (not shown for clarity).
6. Membrane end laps to be a minimum 6" and fully adhered at all membrane to membrane seams.
7. Membrane laps at flanged metal to be 3" minimum and fully bonded to primed metal surface.
8. Use only when roof deck is support by the wall.

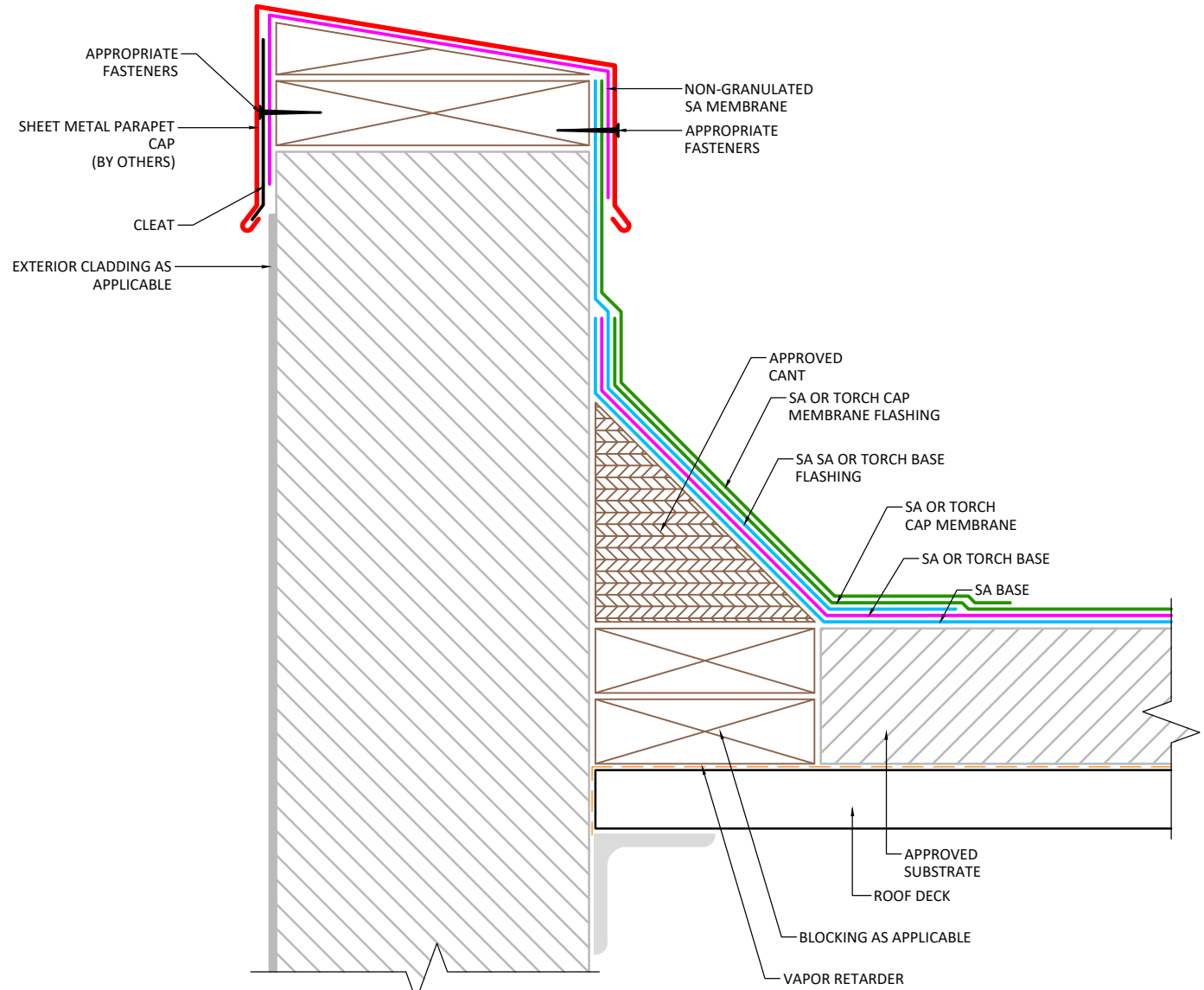

APPLICABLE SYSTEMS (AND MEMBRANES)  
 SELF ADHERED  
 TORCH APPLIED

**MULEHIDE**

PARAPET WALL FLASHING WITH METAL COPING

**DETAIL NO.:**  
**MB-WF-A200**

MAXIMUM WARRANTY:  
 20 YEARS MAX

REVISION DATE: 6/8/2026