

NOTES:

1. Minimum two plies of cap sheet membrane on vertical surfaces is required. Refer to specific details.
2. Approved insulation may be hot mopped to primed structural concrete deck. Contact Mule-Hide for specific information and requirements.

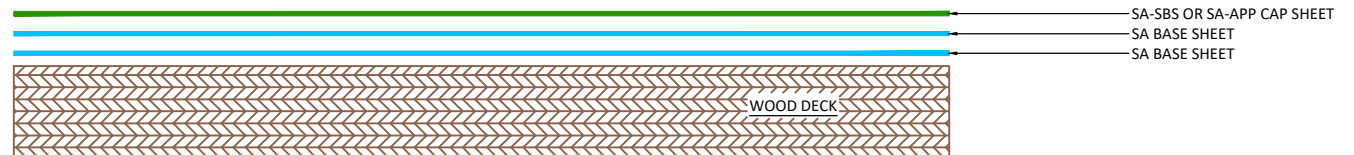
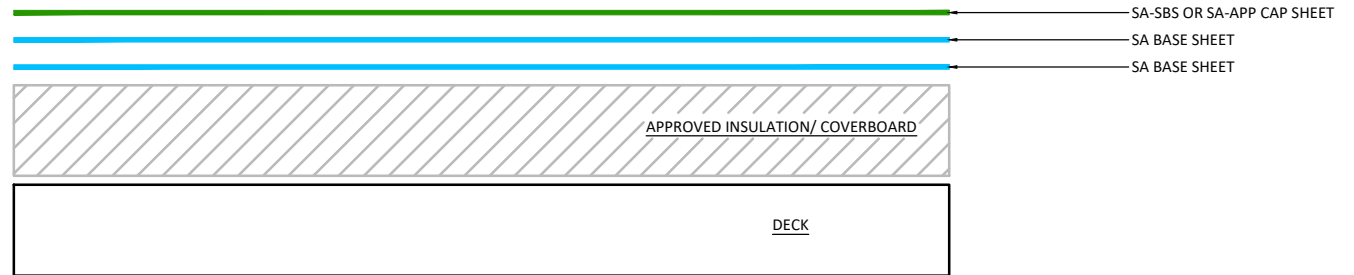
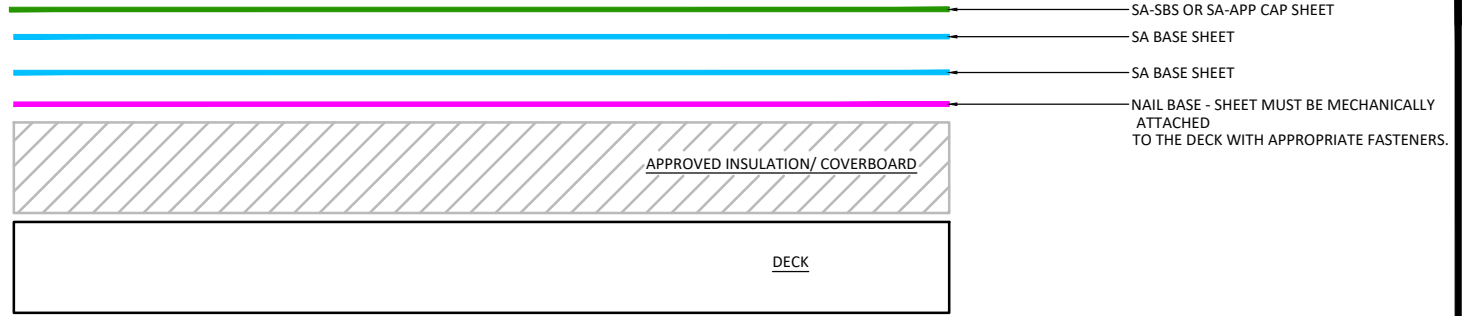

APPLICABLE SYSTEMS (AND MEMBRANES):
SELF-ADHERING MOD BIT SYSTEMS

MULEHIDE

20 YEAR MEMBRANE ASSEMBLIES

MAXIMUM WARRANTY:
20 YEARS MAX

DETAIL NO.:
MB-MS-A805

REVISION DATE: 6/8/2026