

NOTES:

1. Refer to specifications for flashing membrane requirements.
2. Do not install sleepers over fastener plates or seams.
2. Wood nailers matching the insulation thickness are required when the weight supported by the sleeper will crush the insulation.
3. Cap sheet must be heated and granules embedded in surface at all laps over granulated surfaces when installing cap sheet.

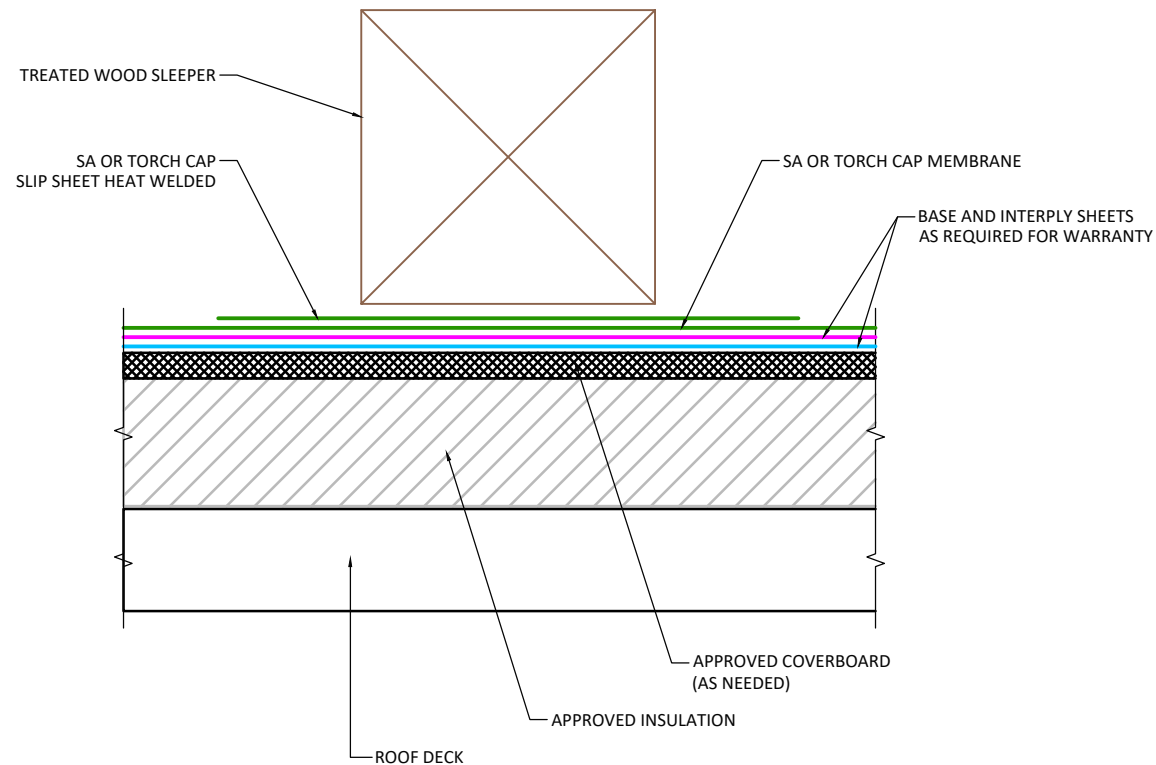

APPLICABLE SYSTEMS (AND MEMBRANES):  
SELF ADHERED  
TORCH APPLIED

**MULEHIDE**

SLEEPER

MAXIMUM WARRANTY:  
20 YEARS MAX

**DETAIL NO.:**

**MB-MS-A801**

REVISION DATE: 6/8/2026