

NOTES:

1. Refer to specifications for flashing membrane requirements.
2. Temperature of metal sleeve must not exceed 160 °F.
3. Cap sheet must be heated and granules embedded in surface at all laps over granulated surfaces when installing cap sheet.

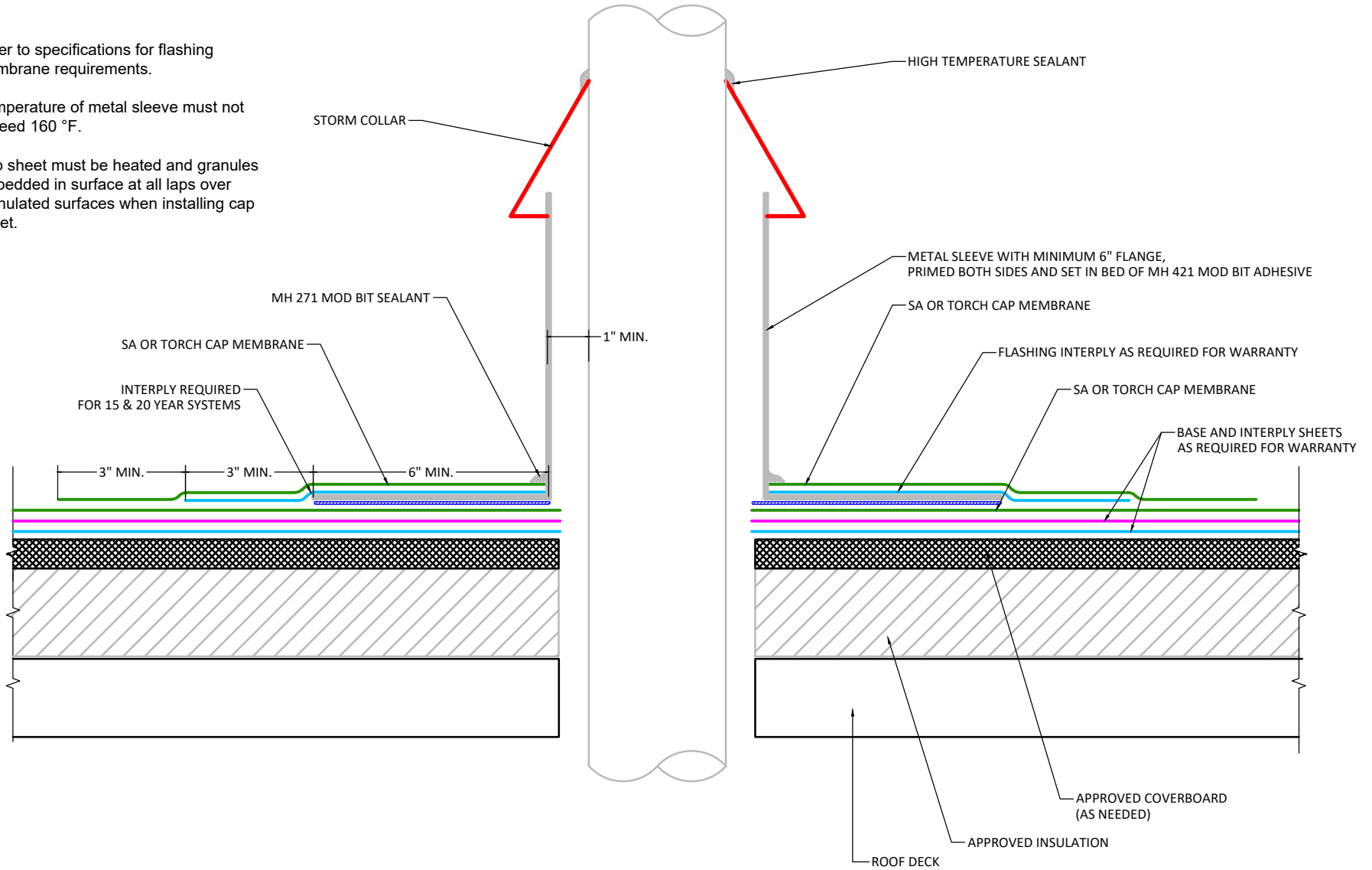

APPLICABLE SYSTEMS (AND MEMBRANES):
 SELF ADHERED
 TORCH APPLIED

MULEHIDE

HOT STACK

DETAIL NO.:

MB-PP-A305

MAXIMUM WARRANTY:
 20 YEARS MAX

REVISION DATE: 6/8/2026