

NOTES:

1. Refer to specifications for flashing membrane requirements.
2. Wood nailers matching the insulation thickness and extending beyond the flange are required.
3. Cap sheet must be heated and granules embedded in surface at all laps over granulated surfaces when installing cap sheet.

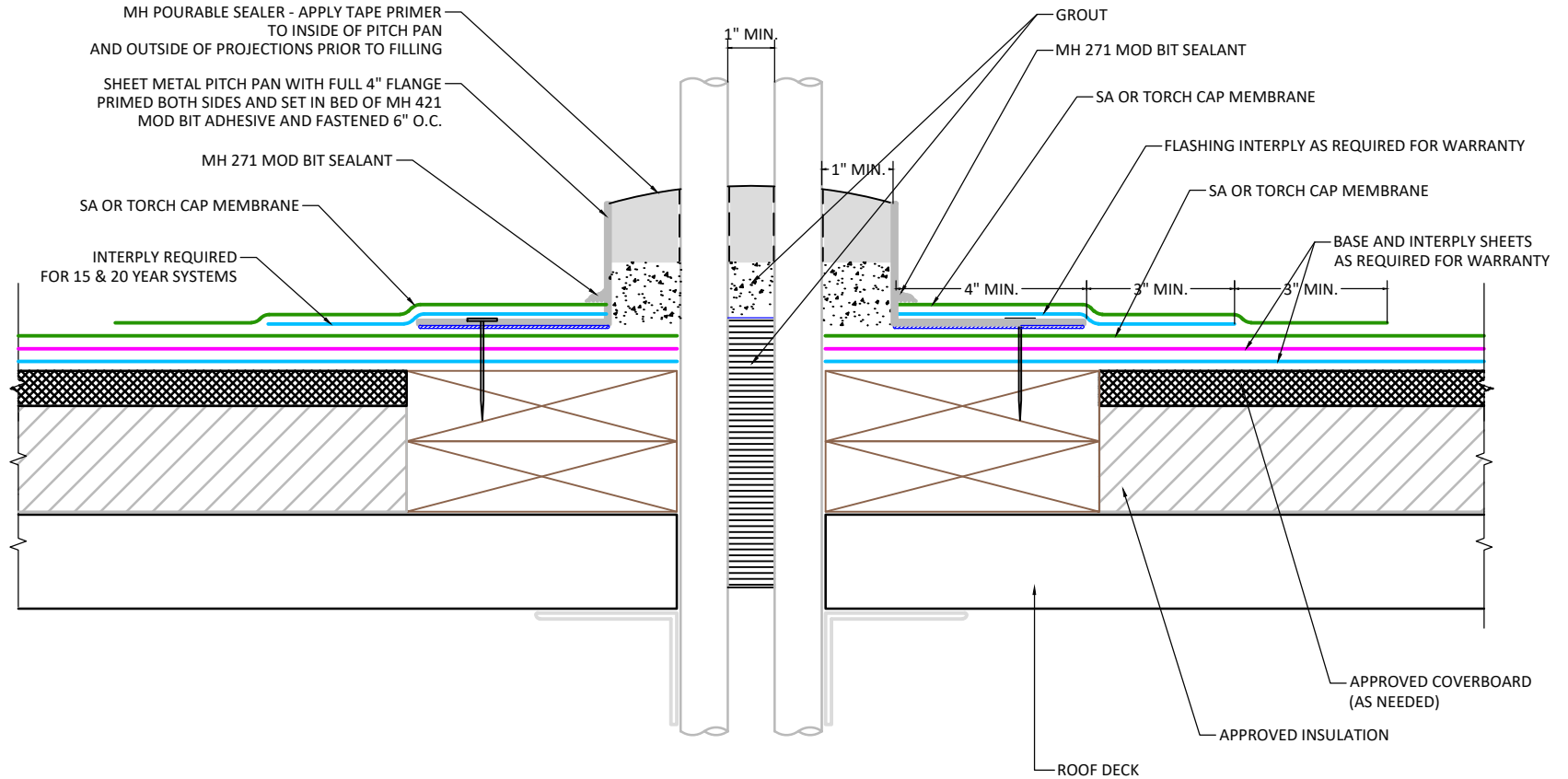

APPLICABLE SYSTEMS (AND MEMBRANES):  
 SELF ADHERED  
 TORCH APPLIED

**MULEHIDE**

PENETRATION POCKET

MAXIMUM WARRANTY:  
 20 YEARS MAX

**DETAIL NO.:**

**MB-PP-A306**

REVISION DATE: 6/8/2026