

NOTES:

1. Wood blocking may be slotted for venting of wet-fill decks or other applicable constructions.
2. For heat fused membrane applications, set metal flashing onto heated softened membrane.
3. Membrane end laps to be a minimum 6" and fully adhered at all membrane to membrane seams.
4. Membrane laps at flanged metal to be 3" minimum and fully bonded to primed metal surface.

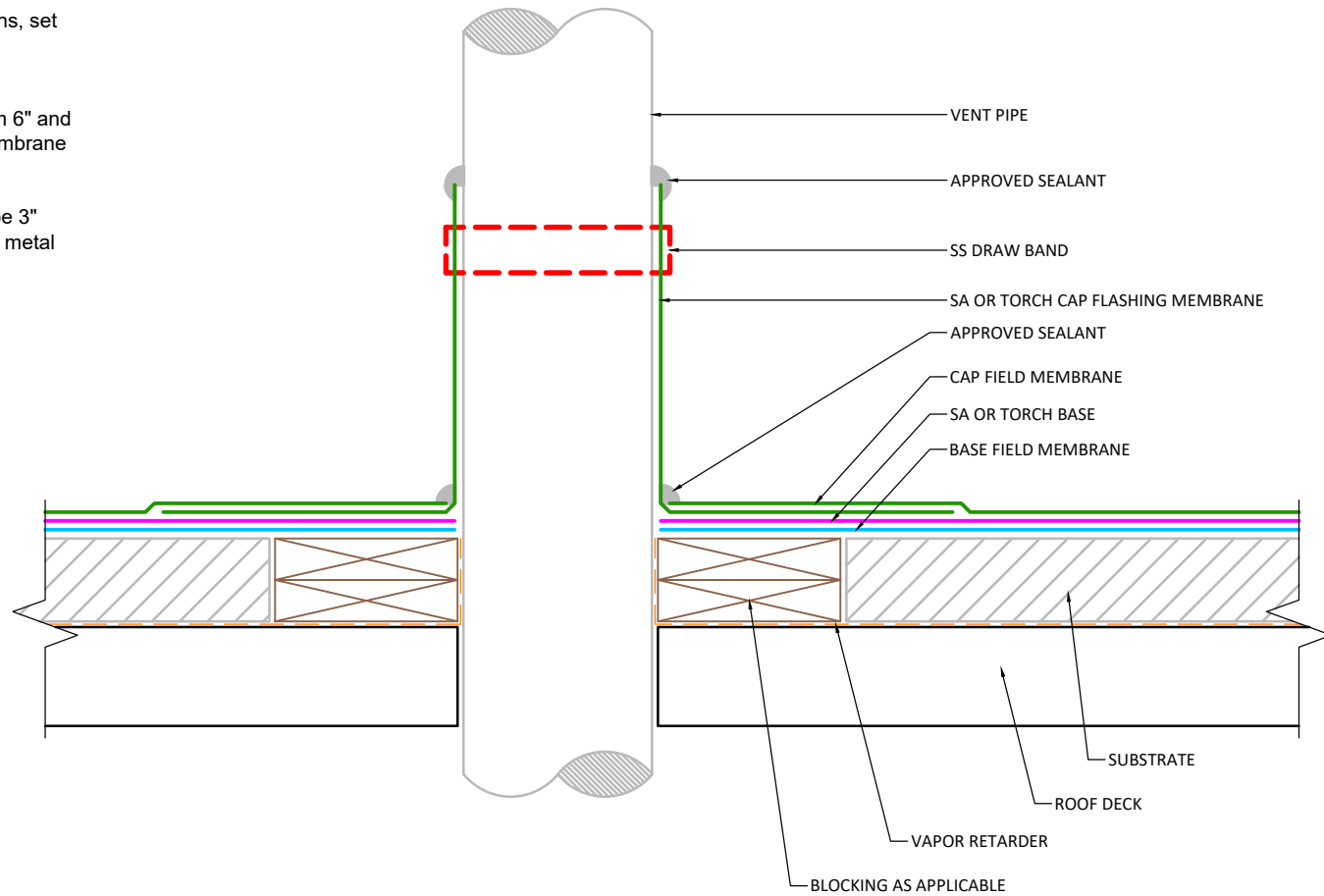

APPLICABLE SYSTEMS (AND MEMBRANES)  
 SELF ADHERED  
 TORCH APPLIED

**MULEHIDE**

VENT PIPE MEMBRANE FLASHING  
 3 PLY APPLICATION WITH VAPOR RETARDER

**DETAIL NO.:**  
**MB-PP-A301**

MAXIMUM WARRANTY:  
 20 YEARS MAX

REVISION DATE: 6/8/2026