

NOTES:

1. Wood blocking may be slotted for venting of wet-fill decks or other applicable constructions.
2. For heat fused membrane applications, set metal flashing onto heated softened membrane.
3. Membrane end laps to be a minimum 6" and fully adhered at all membrane to membrane seams.
4. Membrane laps at flanged metal to be 3" minimum and fully bonded to primed metal surface.
5. Pitch pans interior metals are to be primed prior to being filled with MP Liquid Sealant or approved equal.

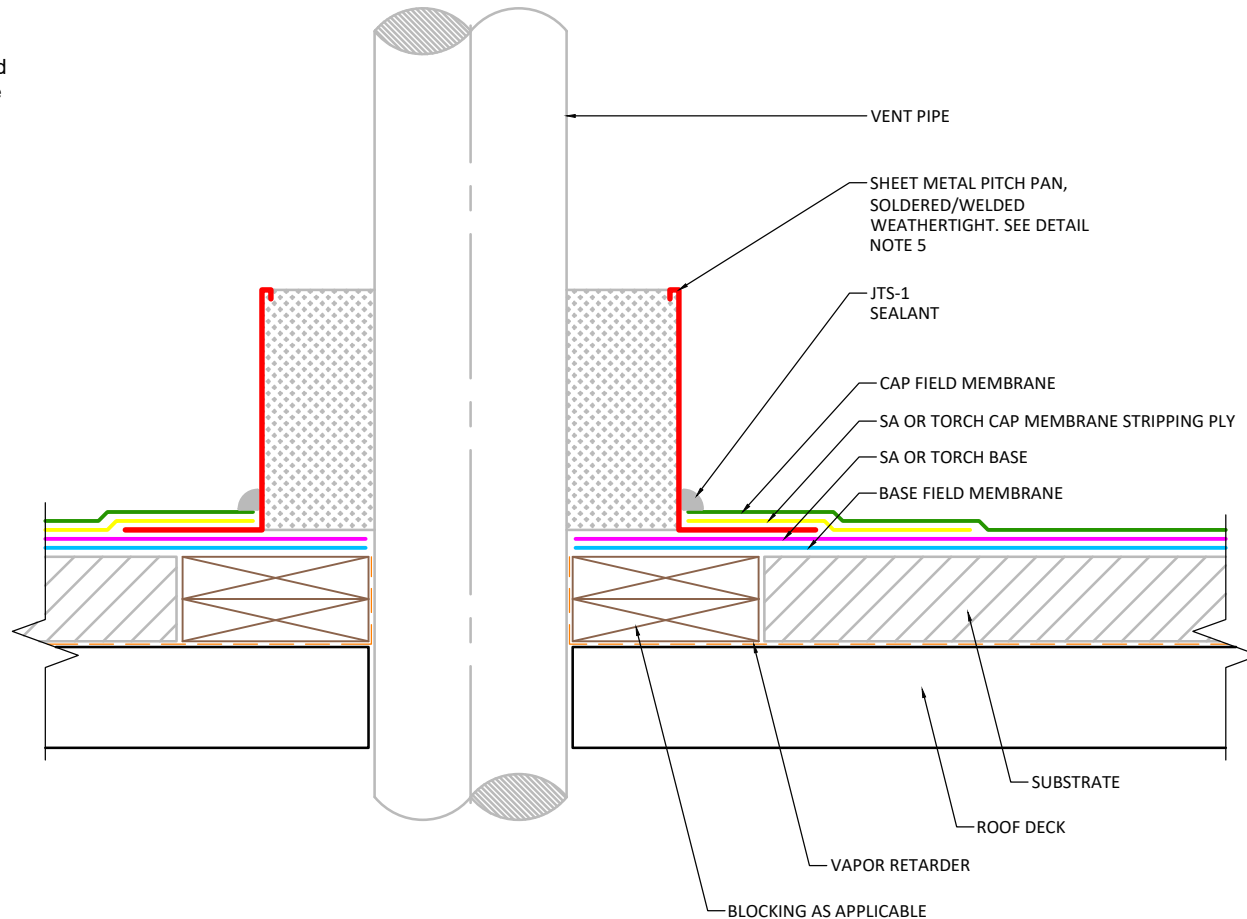

APPLICABLE SYSTEMS (AND MEMBRANES)
SELF ADHERED
TORCH APPLIED

VENT PIPE WITH PITCH POCKET
3 PLY APPLICATION WITH VAPOR RETARDER

MAXIMUM WARRANTY:
20 YEARS MAX

DETAIL NO.:
MB-PP-A303

REVISION DATE: 6/8/2026

MULEHIDE