

NOTES:

1. Refer to specifications for flashing membrane requirements.
2. Wood nailers must be installed with proper fasteners to meet applicable building codes and extend beyond the metal flange.
3. Cap sheet must be heated and granules embedded in surface at all laps over granulated surfaces when installing cap sheet.

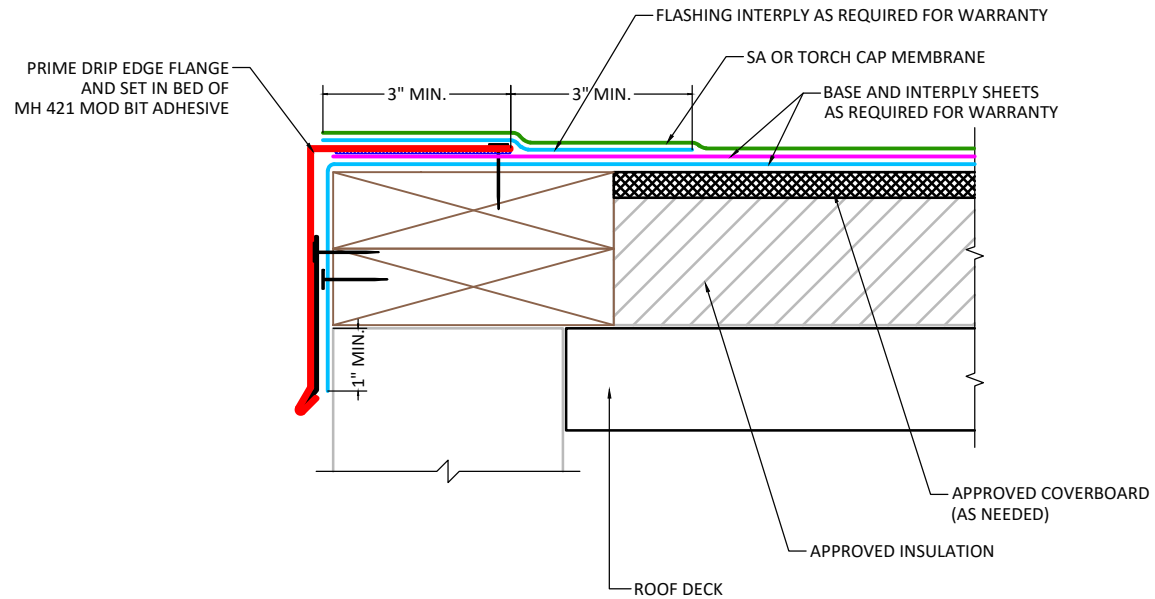
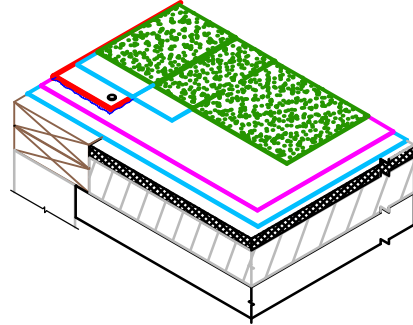

APPLICABLE SYSTEMS (AND MEMBRANES):  
 SELF ADHERED  
 TORCH APPLIED

**MULEHIDE**

DRIP EDGE OPTION 2

MAXIMUM WARRANTY:  
 20 YEARS MAX

**DETAIL NO.:**

**MB-EM-A107**

REVISION DATE: 6/8/2026