

NOTES:

1. Attach wood nailer to wall/deck in accordance with FMRC guidelines as per section 1-28, regarding wind loads to roofing systems and deck securement.
2. Refer to SMACNA recommendations and details for information regarding metal thickness and cleat requirements.
3. Membrane end laps must be 6" minimum and fully adhered to membrane in all locations where "Fastlap" is not present.
4. All acceptable masonry, concrete, metal, and aged wood substrates must be primed with MH 121 asphalt primer (ASTM D 41).
5. Refer to Mule-Hide application guidelines and product data sheets for suitable insulation to accept Mule-Hide Self-Adhering membranes.
6. Insulation must be attached in accordance with Mule-Hide minimum requirements.
7. Non-compatible insulation shall require an approved coverboard to which the SA Base sheet may be adhered. Certain approved coverboards (underlayments) may require priming with MH 121 asphalt primer.
8. For 20 year systems, 2 plies of SA base sheet must be installed.

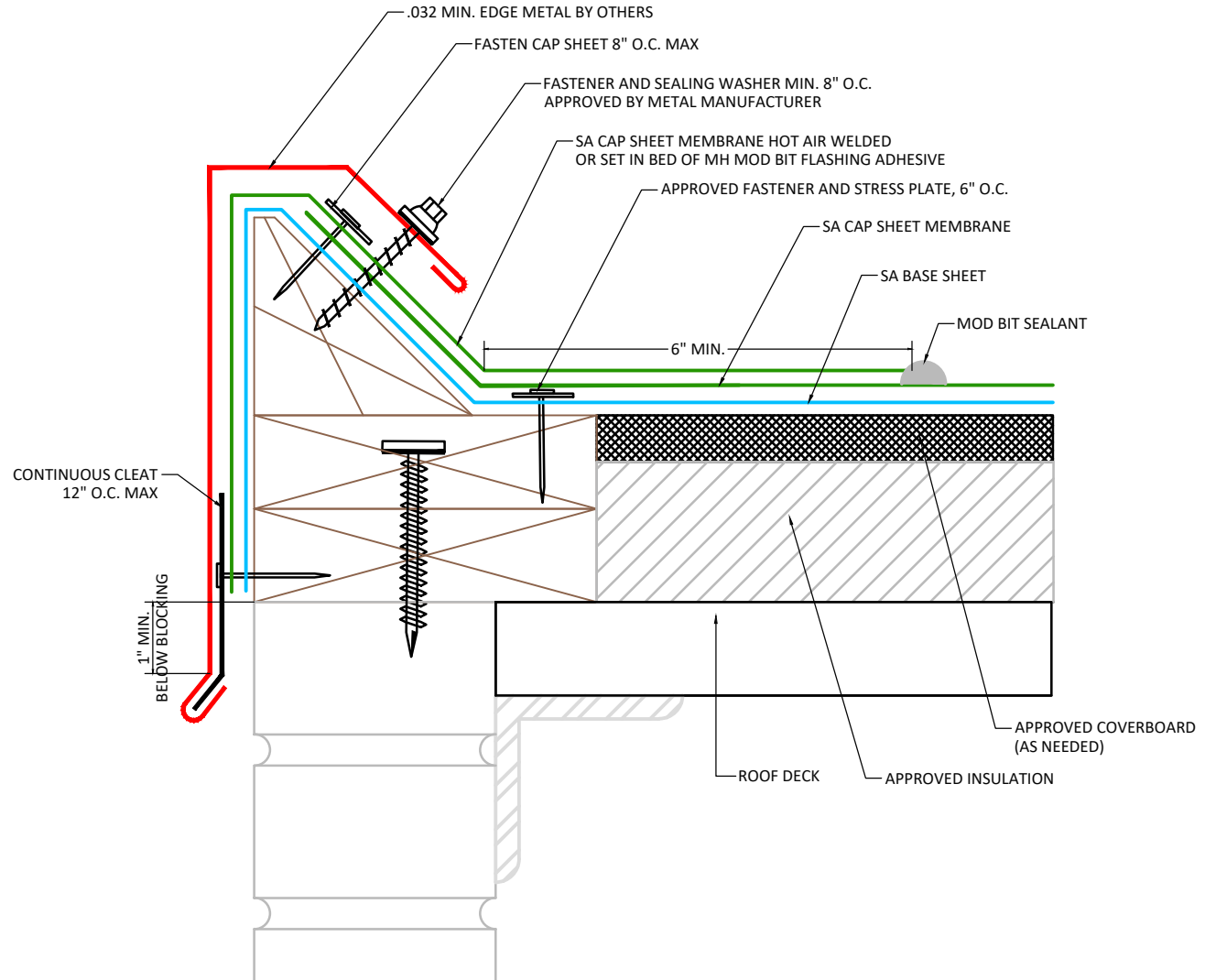

APPLICABLE SYSTEMS (AND MEMBRANES):
SELF-ADHERING MOD BIT SYSTEMS

MULEHIDE

GRAVEL STOP OPTION 1

MAXIMUM WARRANTY:
20 YEARS MAX

DETAIL NO.:

MB-EM-A108

REVISION DATE: 6/8/2026