

NOTES:

1. THIS SYSTEM MUST HAVE WRITTEN APPROVAL FROM MULE-HIDE TECHNICAL DEPARTMENT.
2. TPO SHEETS MAY NOT END ON FASTENER PLATES.

OPTION B: MEMBRANE PARALLEL TO SLOPE

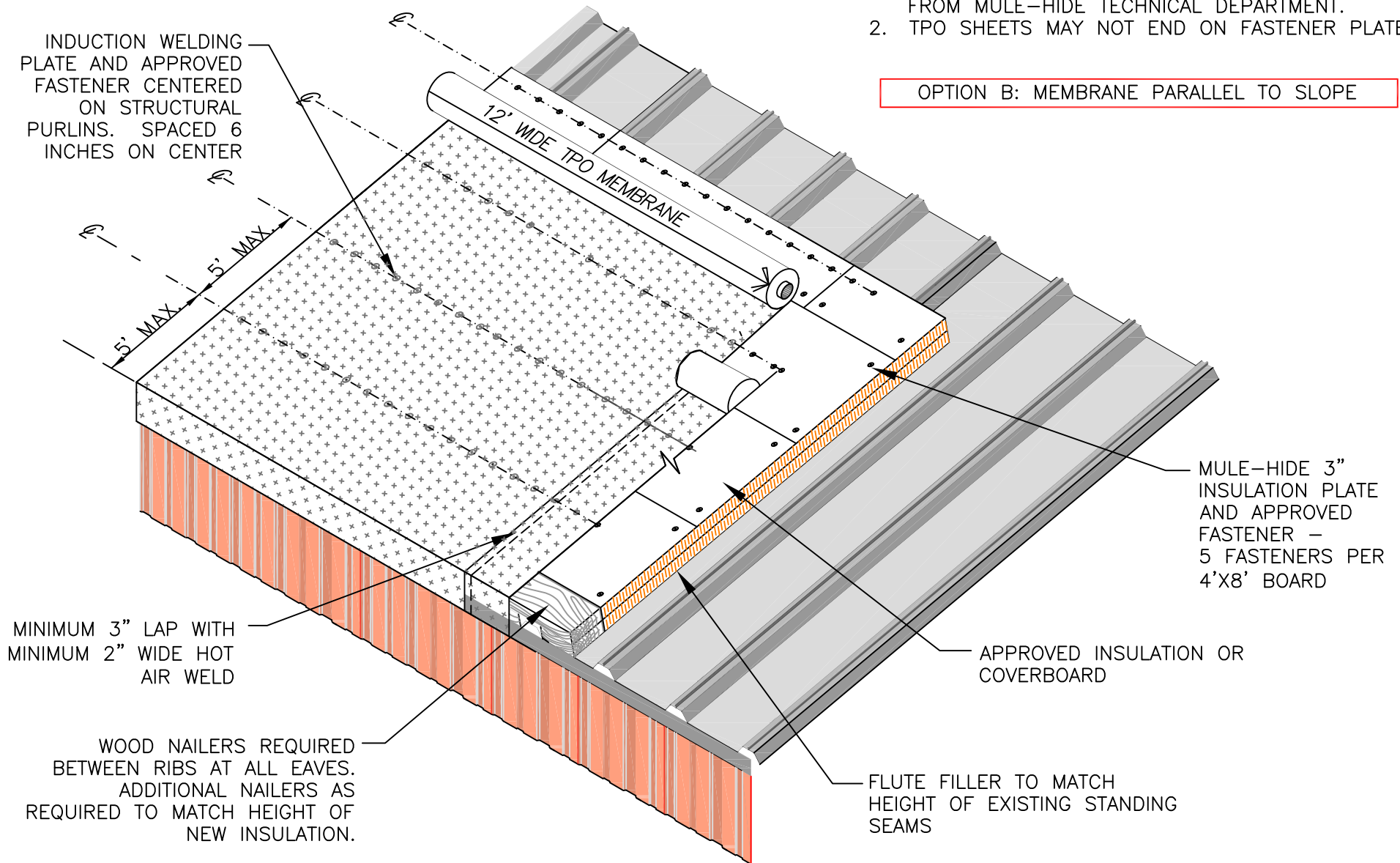

**MULE-HIDE
PRODUCTS CO., INC.**

**INDUCTION WELDING PLATES
WIND ZONES 101-120 MPH
SYSTEMS:
METAL RETROFIT
TPO/PVC MECHANICALLY FASTENED**

DETAIL NO.:
MMRR-305RT

REVISION DATE: 05/2020