



COUNTERFLASHING

2-PIECE REGLET

NOTES

- Pre-Notched Lap Joints
- No Fasteners Provided

NON-CURING SEALANT
(BY OTHERS)

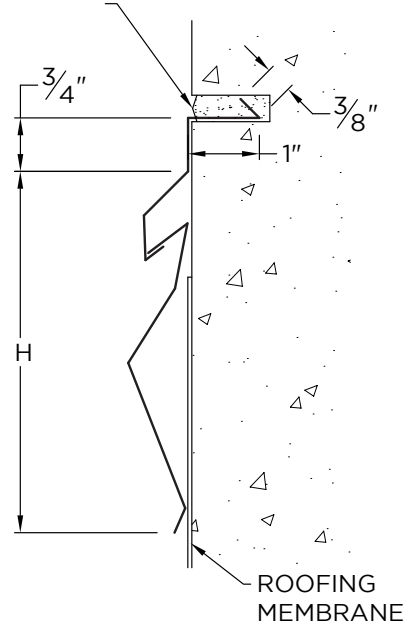

DIMENSIONS

Face Height (H)

- ☐ 3.5" (CFR2-350R)
- ☐ 4" (CFR2-400R)
- ☐ 5" (CFR2-500R)

MATERIAL

- ☐ 24 Ga. Galv. Steel
- ☐ 22 Ga. Galv. Steel
- ☐ .040" Aluminum
- ☐ .050" Aluminum

Color: _____

Finish: _____

☐ OTHER: _____

QUANTITIES

_____ Lineal Feet (12'-0" Lengths)

PROJECT INFO

Project Name: _____

Architect: _____

Roofing Contractor: _____

Project Type: _____



By selecting this box you have verified and confirmed that dimensions, sizes, and quantities are correct. All products will be installed in strict accordance with printed instructions.

Date: _____

MuleHide
1195 Prince Hall Drive
Beloit, WI 53511

800-786-1492
www.mulehide.com

To submit a quote request, please
contact your local TM or email
mhquotes@metalera.com.

SHT #: _____ of _____

DATE: **04/10/25**

DRN BY: **JJC**

CKD BY: **MM**

DWG #: **52015-42345**

REV: **B**