

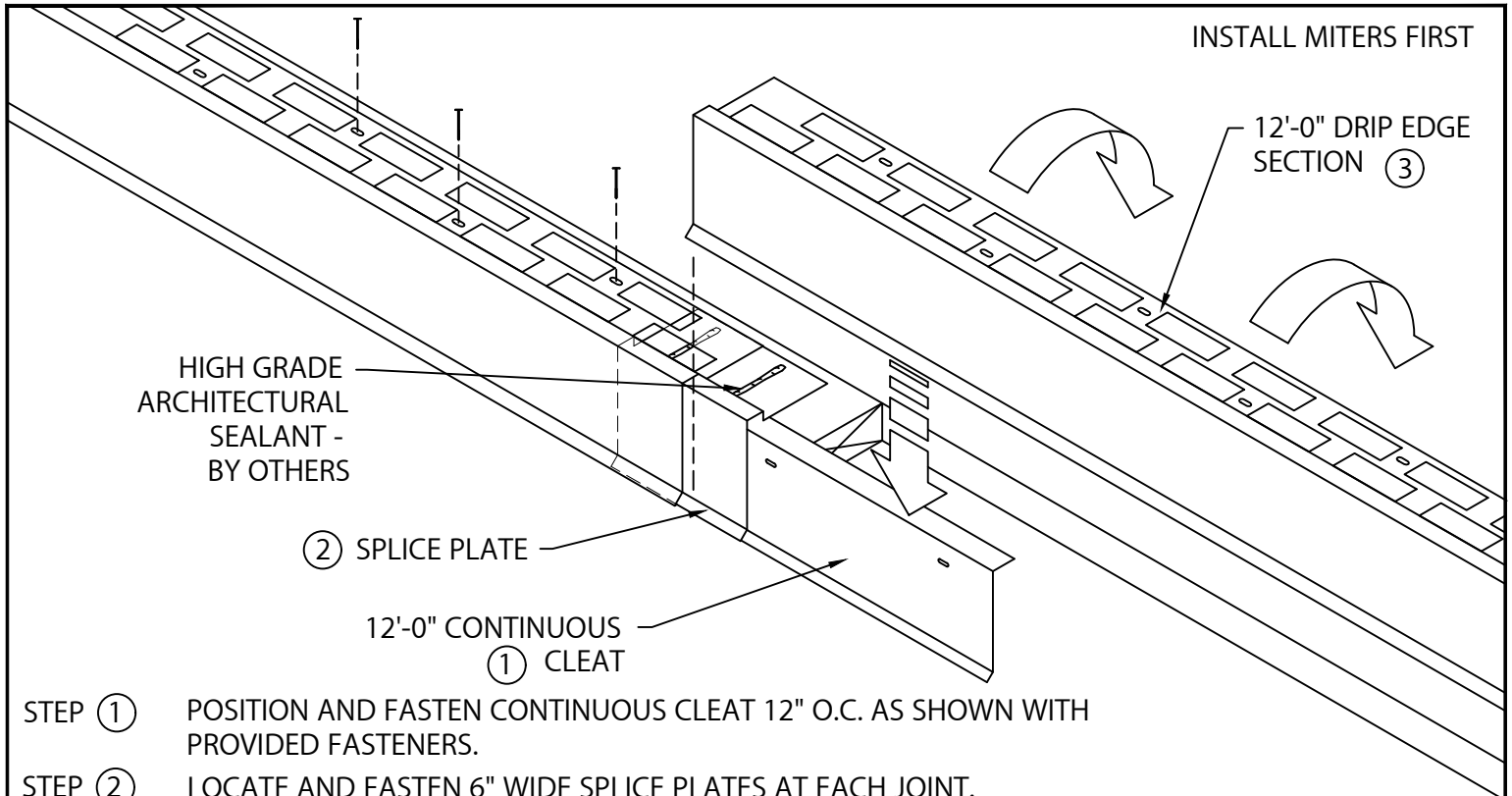

DRIP EDGE MB

BUILT-UP OR MODIFIED VERSION
INSTALLATION INSTRUCTIONS



INSTALL MITERS FIRST

12'-0" DRIP EDGE SECTION (3)

HIGH GRADE
ARCHITECTURAL
SEALANT -
BY OTHERS

(2) SPLICE PLATE

12'-0" CONTINUOUS
(1) CLEAT

STEP (1) POSITION AND FASTEN CONTINUOUS CLEAT 12" O.C. AS SHOWN WITH PROVIDED FASTENERS.

STEP (2) LOCATE AND FASTEN 6" WIDE SPLICE PLATES AT EACH JOINT. SEALANT (BY OTHERS) TO BE FIELD APPLIED TO TOP OF EACH SPLICE PLATE AS SHOWN.

STEP (3) HOOK DRIP EDGE OF EACH DRIP EDGE SECTION ONTO CONTINUOUS CLEAT, ROTATE INTO PLACE, AND FASTEN WITH PROVIDED FASTENERS.

FASTEN DRIP EDGE
AND CONTINUOUS CLEAT
WITH PROVIDED
FASTENERS

3/8" SPACE

STEP (4)

CONTINUE BY INSTALLING DRIP EDGE SECTIONS ALLOWING A 3/8" SPACE BETWEEN SECTIONS AS SHOWN. FIELD CUT AS NECESSARY. REMOVE PROTECTIVE FILM IMMEDIATELY AFTER INSTALLATION. INSTALLERS SHALL WEAR PROTECTIVE EYEWEAR TO PREVENT INJURY.

TYPICAL INSTALLATION

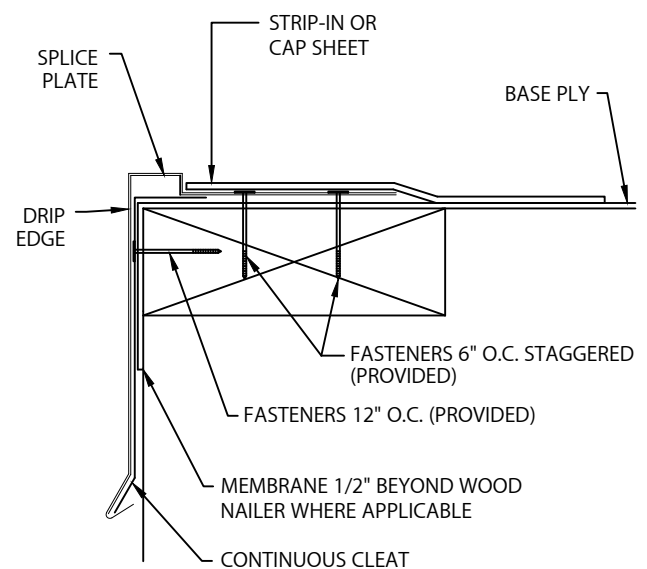

1195 PRINCE HALL DRIVE
BELIOT, WI 53511
800-786-1492
WWW.MULEHIDE.COM

DATE: 03/25/24
DRN BY: MLM
CKD BY: MM

SHT.# ____ OF ____

DWG# 52110-42587

A