

# Summary Specification

"The name trusted in roofing since 1906"



## APP TORCH

### 12 – Year Material Warranty Insulated deck

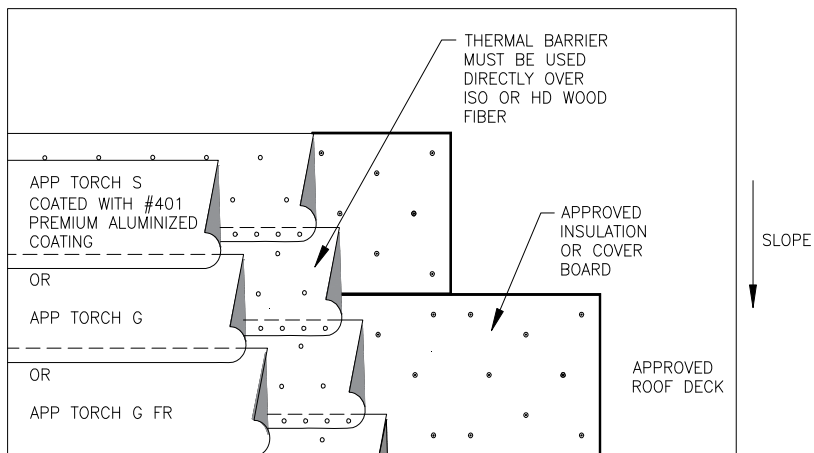

Deck Requirement
• 2500 psi Concrete <sup>(1)</sup>
• 22 gauge Steel
Lightweight • Insulation Concrete over Metal <sup>(2)</sup>
• Min. 1" Wood Plank
• Min 15/32" Plywood/OSB
• Cementitious Wood Fiber <sup>(2)</sup>
• Gypsum <sup>(1), (2)</sup>

Insulation
• Min. 1-1/2" Polyisocyanurate <sup>(3)</sup>
• Min 1/2" HD Woodfiber <sup>(3)</sup>
• Min. 1/2" Extruded Polystyrene <sup>(4)</sup>
• Min. 1/2" Expanded Polystyrene <sup>(4)</sup>
• Min. 1" Rockwool <sup>(5)</sup>

Cover Board
• Min. 1/4" Dens Deck Prime <sup>(5)</sup>
• Min. 1/4" Securock <sup>(5)</sup>
Thermal Barrier
G2 Base • mechanically attached
Nail Base • mechanically attached
• SA Base <sup>(6)</sup>

Slope Requirement
1/4" per foot

Base Sheet
• None

Cap Sheet
• APP Torch S <sup>(7)</sup>
• APP Torch G
• APP Torch G FR

# Summary Specification

*"The name trusted in roofing since 1906"*



## Notes:

1. Insulation may be attached to deck with either mechanical fasteners, foam adhesive, or hot asphalt.
2. Pull out test are required prior to installation.
3. Approved cover board or thermal barrier must be installed over insulation.
4. Approved cover board must be installed over insulation.
5. Direct torching to insulation/cover board or mechanically attached thermal barrier is approved.
6. SA Base used as a thermal barrier is only approved over polyisocyanurate or high density fiberboard insulation. If SA Base is used, ambient temperatures must be 50° F and rising.
7. APP Torch S must be coated with #401 Premium Fibrated Aluminized Coating at a rate of 1 – 1.5 gallons per 100 square feet.
8. Flashings are to be one layer of Cap Sheet installed in accordance with Mule-Hide Standard Details.

**PRODUCTS NOT SUPPLIED BY MULE-HIDE PRODUCTS ARE NOT COVERED UNDER THE MULE-HIDE WARRANTY**

***PLEASE CONSULT THE MULE-HIDE WEBSITE FOR THE MOST CURRENT INFORMATION AT [WWW.MULEHIDE.COM](http://WWW.MULEHIDE.COM)***