

# Summary Specification

"The name trusted in roofing since 1906"



## APP TORCH

### 20 – Year Material or System Warranty Insulated deck

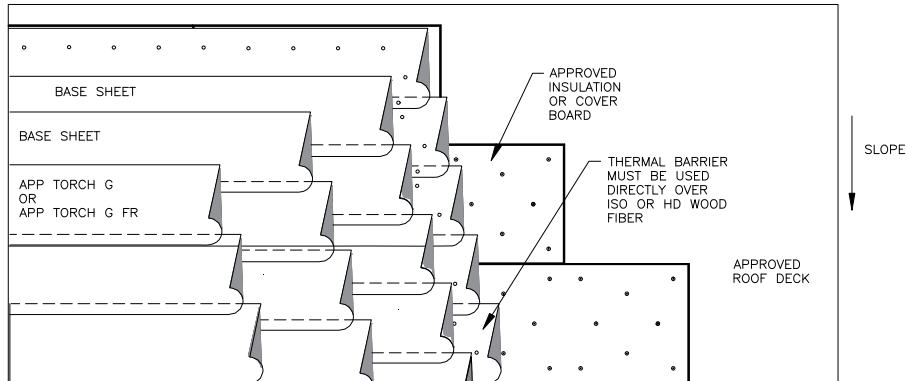

Deck Requirement	Insulation	Cover Board
<ul style="list-style-type: none"> <li>2500 psi Concrete<sup>(1)</sup></li> </ul>	<ul style="list-style-type: none"> <li>Min. 1-1/2" Polyisocyanurate<sup>(3)</sup></li> </ul>	<ul style="list-style-type: none"> <li>Min. 1/4" Dens Deck Prime<sup>(5)</sup></li> </ul>
<ul style="list-style-type: none"> <li>22 gauge Steel</li> </ul>	<ul style="list-style-type: none"> <li>Min 1/2" HD Woodfiber<sup>(3)</sup></li> </ul>	<ul style="list-style-type: none"> <li>Min. 1/4" Securock<sup>(5)</sup></li> </ul>
Lightweight <ul style="list-style-type: none"> <li>Insulation Concrete over Metal<sup>(2)</sup></li> </ul>	<ul style="list-style-type: none"> <li>Min. 1/2" Extruded Polystyrene<sup>(4)</sup></li> </ul>	<b>Thermal Barrier</b>
<ul style="list-style-type: none"> <li>Min. 1" Wood Plank</li> </ul>	<ul style="list-style-type: none"> <li>Min. 1/2" Expanded Polystyrene<sup>(4)</sup></li> </ul>	<ul style="list-style-type: none"> <li>G2 Base</li> <li>mechanically attached</li> </ul>
<ul style="list-style-type: none"> <li>Min 15/32" Plywood/OSB</li> </ul>	<ul style="list-style-type: none"> <li>Min. 1" Rockwool<sup>(5)</sup></li> </ul>	<ul style="list-style-type: none"> <li>Nail Base</li> <li>mechanically attached</li> </ul>
<ul style="list-style-type: none"> <li>Cementitious Wood Fiber<sup>(2)</sup></li> </ul>		<ul style="list-style-type: none"> <li>SA Base<sup>(6), (8)</sup></li> </ul>
<ul style="list-style-type: none"> <li>Gypsum<sup>(1), (2)</sup></li> </ul>		
<b>Slope Requirement</b>		
1/4" per foot		

Base Sheet <sup>(7)</sup>	Cap Sheet
<ul style="list-style-type: none"> <li>APP Torch Base</li> </ul>	<ul style="list-style-type: none"> <li>APP Torch G</li> </ul>
<ul style="list-style-type: none"> <li>SA Base</li> </ul>	<ul style="list-style-type: none"> <li>APP Torch G FR</li> </ul>

# Summary Specification

*"The name trusted in roofing since 1906"*



## Notes:

1. Insulation may be attached to deck with either mechanical fasteners, foam adhesive, or hot asphalt.
2. Pull out test are required prior to installation.
3. Approved cover board or thermal barrier must be installed over insulation.
4. Approved cover board must be installed over insulation.
5. Direct torching to insulation/cover board or mechanically attached thermal barrier is approved.
6. SA Base used as a thermal barrier is only approved over polyisocyanurate insulation. If SA Base is used, ambient temperatures must be 50° F and rising.
7. Two interply layers of approved Base Sheet are required.
8. SA Base used as a thermal barrier qualifies as an interply layer.
9. Flashings are to be one layer of approved Base Sheet and one layer of Cap Sheet installed in accordance with Mule-Hide Standard Details.

**PRODUCTS NOT SUPPLIED BY MULE-HIDE PRODUCTS ARE NOT COVERED UNDER THE MULE-HIDE WARRANTY**

***PLEASE CONSULT THE MULE-HIDE WEBSITE FOR THE MOST CURRENT INFORMATION AT [WWW.MULEHIDE.COM](http://WWW.MULEHIDE.COM)***