

6" (23 cm) WIDE MULE-HIDE .045" RMS W/TAPE

MULE-HIDE 2" BARBED SEAM PLATE AND MULE-HIDE HD FASTENER MAX. 12" (30 cm) O.C.

MULE-HIDE 90 MIL EPDM MEMBRANE

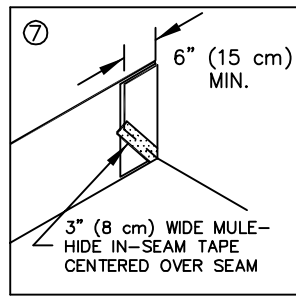
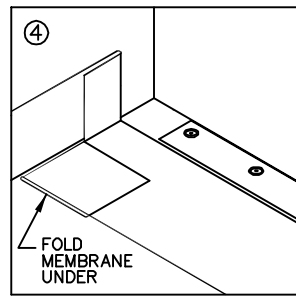

COMPLETE VERTICAL SEAM AND APPLY 3" (8 cm) WIDE MULE-HIDE IN-SEAM TAPE TO THE SEAM EDGE AS SHOWN

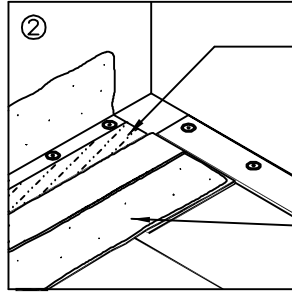

6" (15 cm) WIDE IN-SEAM TAPE

MULE-HIDE BONDING ADHESIVE

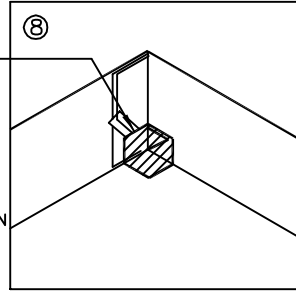
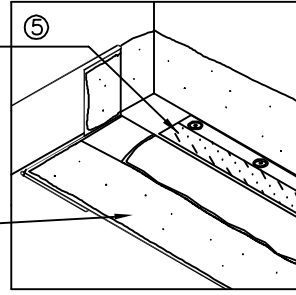

APPROX. 9" X 9" (23 x 23 cm) MULE-HIDE UNCURED FLASHING TAPE (SIMILAR TO DETAIL MHE-514)

MULE-HIDE UNCURED FLASHING TAPE MUST BE USED IN CONJUNCTION WITH TAPE PRIMER

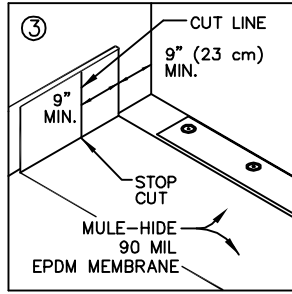

NOTES:

1. FOR RMS SECUREMENT, REFER TO DETAIL MHE-521

MULE-HIDE 6" (15 cm) WIDE IN-SEAM TAPE

MULE-HIDE 90 MIL EPDM MEMBRANE

CUT 45°

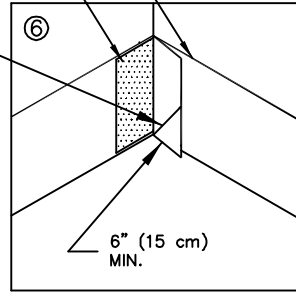

APPLY 9" X 9" (23 x 23 cm) MULE-HIDE UNCURED FLASHING TAPE ON DECK MEMBRANE AND 9" X 12" (23 x 30 cm) UNCURED FLASHING TAPE ON WALL AT CORNER AS SHOWN (SIMILAR TO DETAIL MHE-514)

CAULK ALL EDGES WITH LAP SEALANT (SIMILAR TO DETAIL MHE-514)

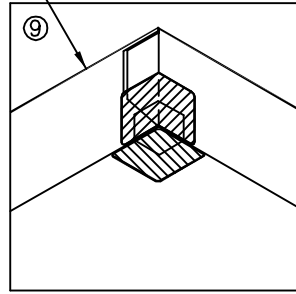

ANY MHE-522 TERMINATION

**MULE-HIDE PRODUCTS CO., INC.**  
**2005**

Inside Corner With Continuous EPDM Wall Flashing  
SYSTEMS:  
Fully Adhered 90mil System

DETAIL NO.:  
**MHE-515**