

NOTES:

1. ROOF DRAIN SIZE AND NUMBER OF DRAINS SHALL BE IN ACCORDANCE WITH LOCAL CODES.
2. ALL BOLTS OR CLAMPS MUST BE IN PLACE TO PROVIDE CONSTANT COMPRESSION ON WATER CUT-OFF MASTIC.
3. THE HOLE IN THE MEMBRANE SHALL EXCEED THE DIAMETER OF THE DRAIN PIPE, BUT SHALL BE NO LESS THAN 1/2" (13mm) FROM THE ATTACHMENT POINTS OF THE DRAIN CLAMPING RING.

APPROXIMATE FASTENING LOCATION BELOW THE TARGET

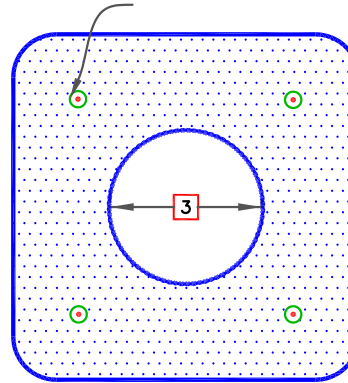

36" X 36" (914mm X 914mm) MULE-HIDE TPO WITH ROUNDED CORNERS

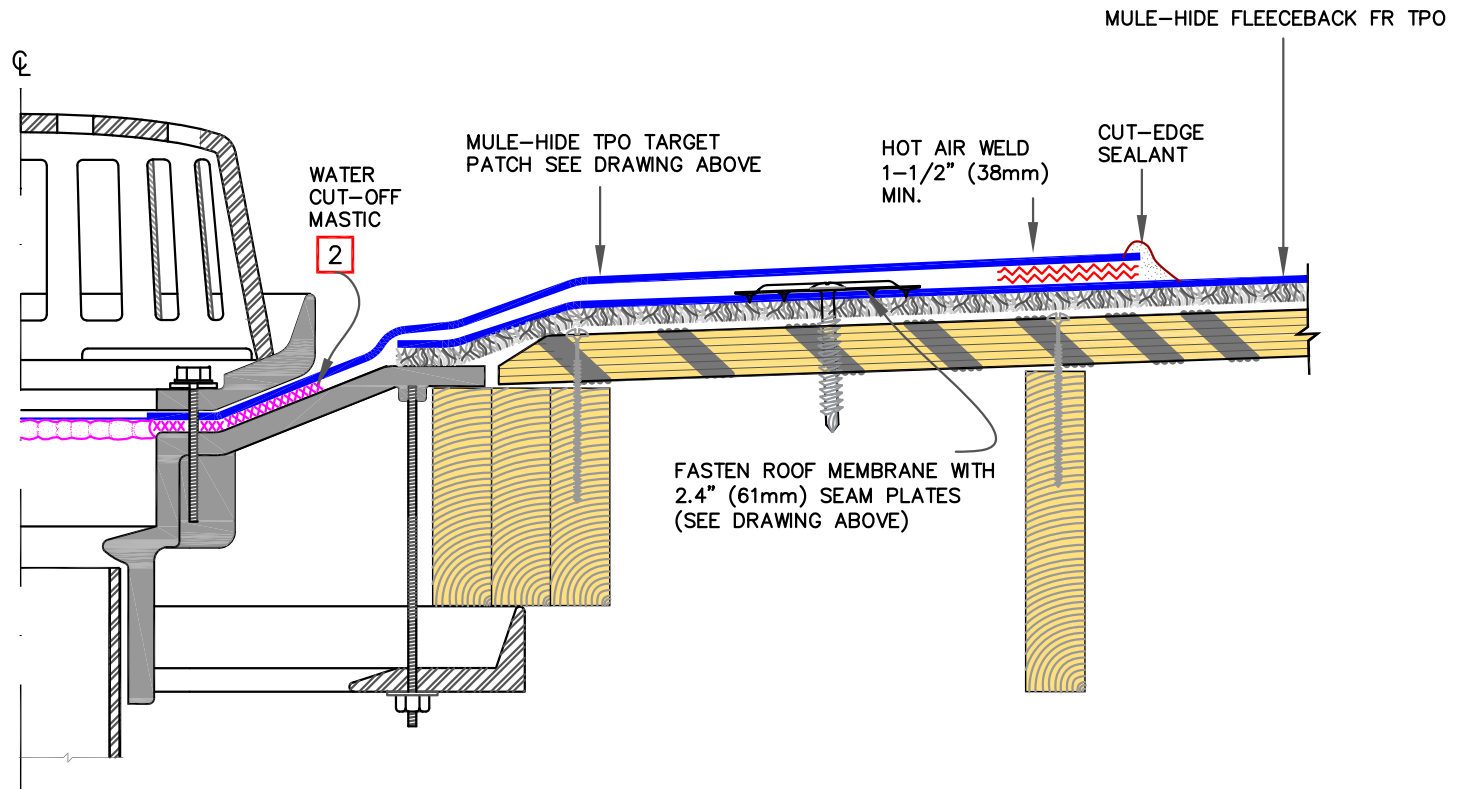

**MULE-HIDE
PRODUCTS CO., INC.**

**DRAIN FLASHING
WITH TARGET
SYSTEMS:**

ALL TPO FLEECEBACK FR

DETAIL NO.:

MHTF-130

REVISION DATE: 09/2018