

NOTES:

1. WATER CUT-OFF MASTIC MUST BE UNDER CONSTANT COMPRESSION.
2. APPLY APPROVED PRIMER TO METAL FLANGE AND MEMBRANE SURFACE PRIOR TO INSTALLING PRESSURE-SENSITIVE FLASHING.
3. CONSULT SPECIFIER OR APPLICABLE CODES FOR ADEQUATE DRAINAGE STRAINER TO AVOID PONDING WATER. DO NOT RESTRICT WATER FLOW.

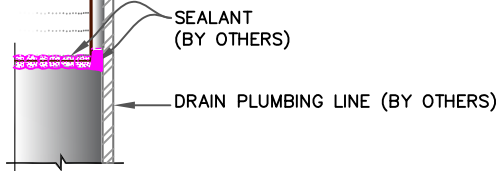

DIMENSIONS	mm	
(A) 2"	51	MIN.
(B) 0.5"-1"	13-25	
(C) 3"	76	

TPO FLEECEBACK FR - INSERT DRAIN THROUGH DECK

**MULE-HIDE
PRODUCTS CO., INC.**

DRAIN INSERT

SYSTEMS:

ALL FLEECE BACK TPO

DETAIL NO.:

MHTF-131

REVISION DATE: 09/2018