

CREASE MEMBRANE AT ANGLE CHANGE TO  
LIMIT BRIDGING TO 3/4" MAXIMUM

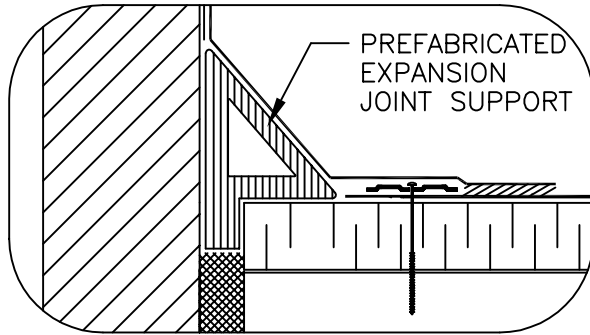

WIDTH OF JOINT SHALL BE A  
MINIMUM OF 3/4" AND SHALL NOT  
EXCEED 2".

NOTES:

1. POSITION FASTENING PLATES 1/2" MINIMUM TO 1" MAXIMUM FROM EDGE OF DECK MEMBRANE.
2. APPROXIMATELY 1/8" DIAMETER BEAD OF EDGE SEALANT IS REQUIRED ON CUT EDGES OF TPO REINFORCED MEMBRANE.
3. TPO BONDING ADHESIVE IS REQUIRED REGARDLESS OF TERMINATION HEIGHT.
4. MULE-HIDE RECOMMENDS THE USE OF CARLISLE'S PREFABRICATED EXPANSION JOINT SUPPORT AS AN OPTION FOR THIS DETAIL.

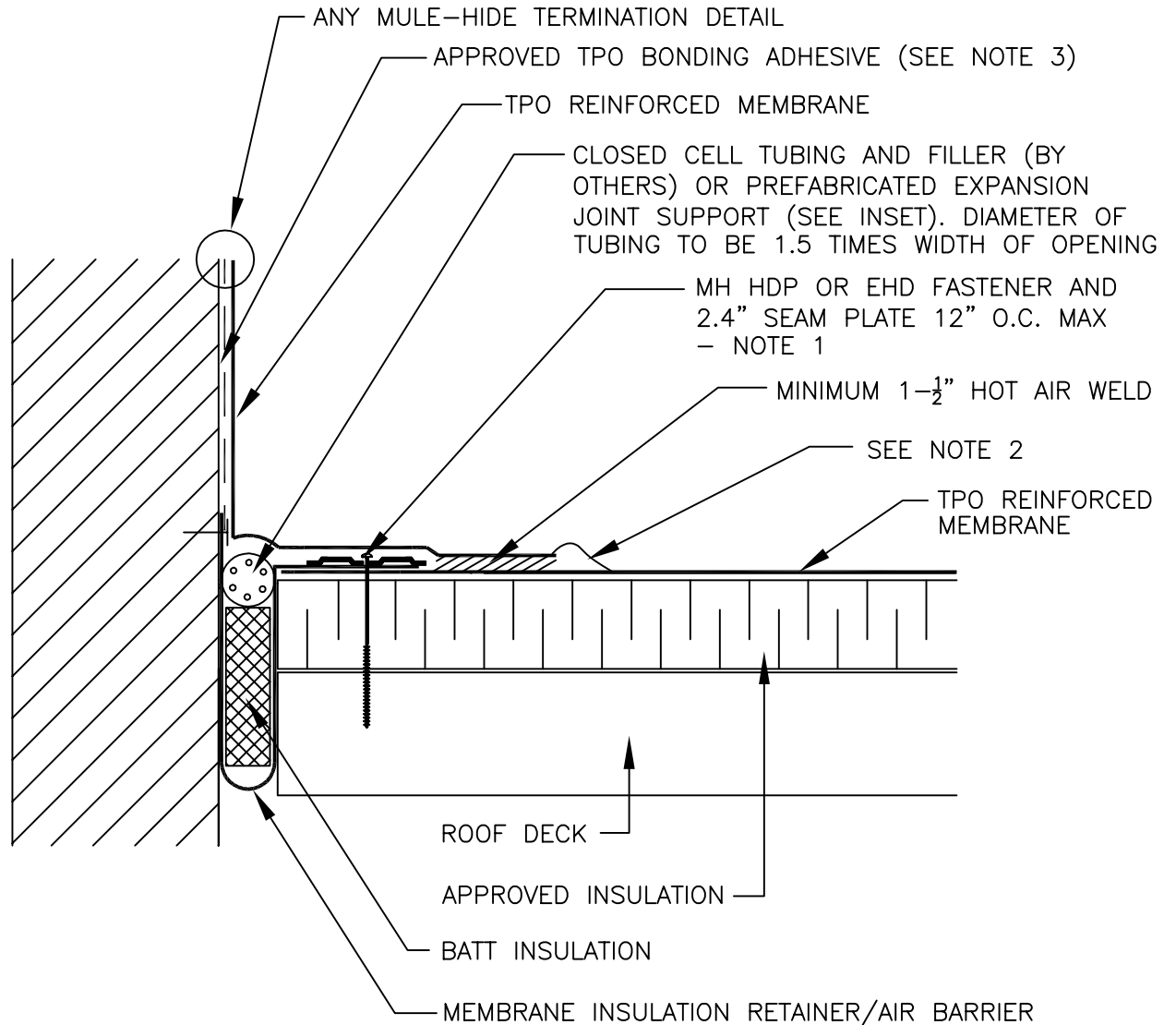

WALL EXPANSION JOINT

SYSTEMS:

ALL TPO SYSTEMS

DETAIL NO.:

**MHT-UN-404B**

REVISION DATE: 10/2013

**MULE-HIDE  
PRODUCTS CO., INC.**