

NOTES:

1. REFER TO SPECIFICATIONS FOR FLASHING MEMBRANE REQUIREMENTS.
2. DO NOT INSTALL SLEEPERS OVER FASTENER PLATES OR SEAMS.
3. WOOD NAILERS MATCHING THE INSULATION THICKNESS IS REQUIRED WHEN THE WEIGHT SUPPORTED BY THE SLEEPER WILL CRUSH THE INSULATION.
4. CAP SHEET MUST BE HEATED AND GRANULES EMBEDDED IN SURFACE AT ALL LAPS OVER GRANULATED SURFACES WHEN INSTALLING THE CAP SHEET.

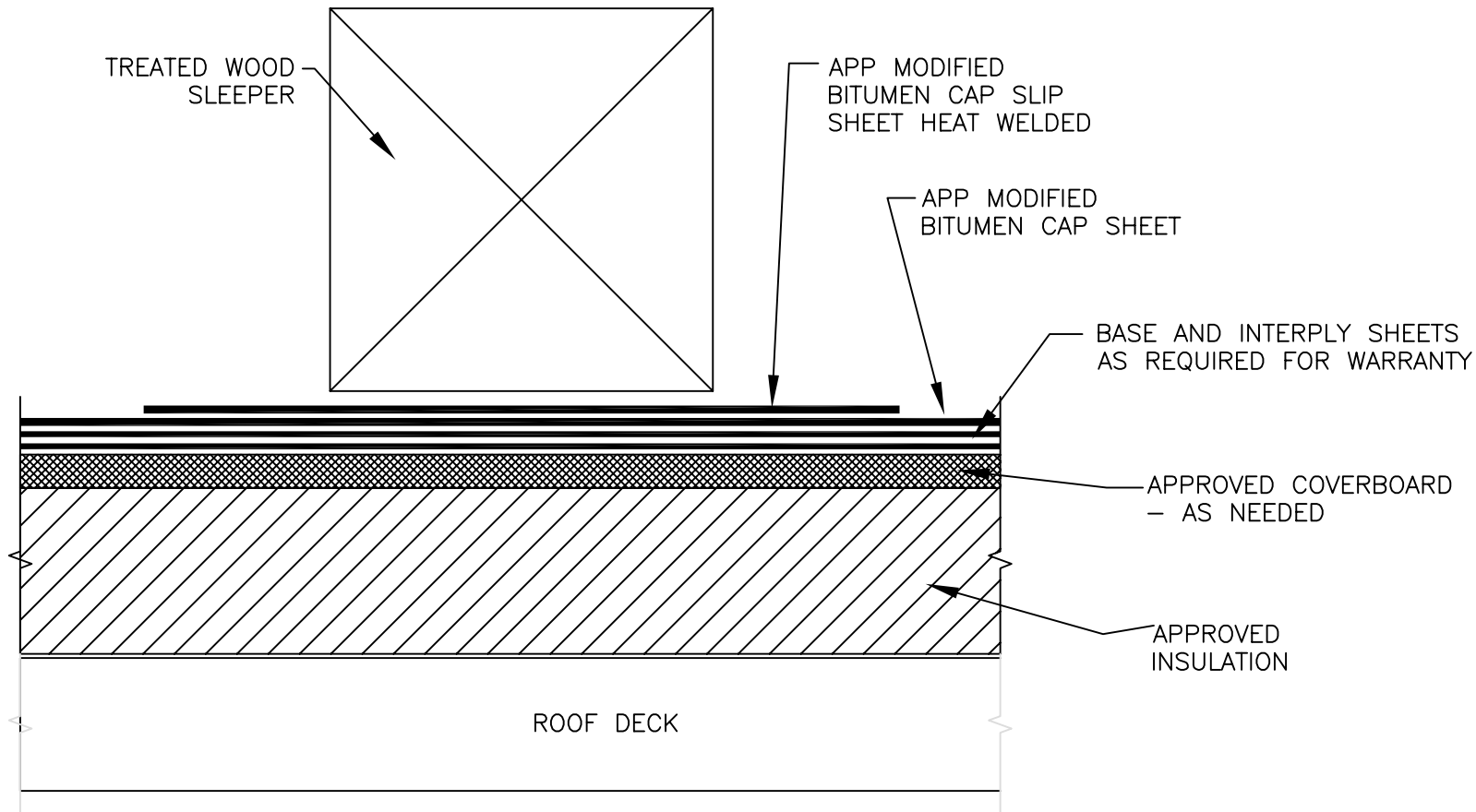

**MULE-HIDE
PRODUCTS CO., INC.**

SLEEPER

SYSTEMS:

APP MODIFIED BITUMEN

DETAIL NO.:

MHMB-UN-PP05T

REVISION DATE: MARCH 2015