

NOTES:

1. THIS DETAIL IS ONLY APPLICABLE TO CONCRETE OR MASONRY WALLS.
2. MINIMUM TERMINATION HEIGHT FOR ALL FLASHINGS IS 8".

NOTE:

THIS DETAIL QUALIFIES TO BE INCLUDED IN ANY MULE-HIDE LABOR AND MATERIAL WARRANTY

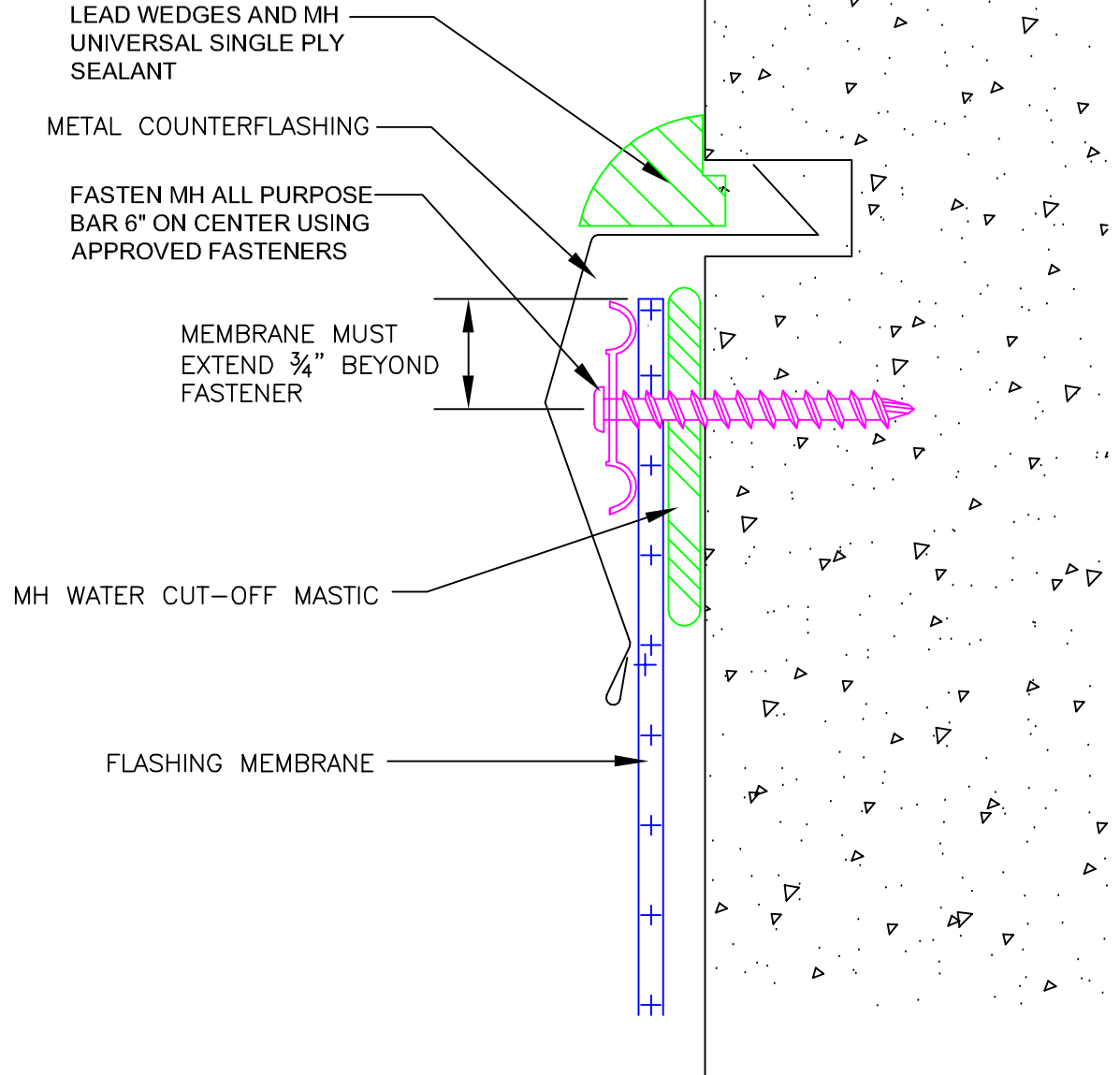

**MULE-HIDE
PRODUCTS CO., INC.**

**MULE-HIDE PREMANUFACTURED
REGLET COUNTERFLASHING
SYSTEMS:**

ALL MULE-HIDE SYSTEMS

DETAIL NO.:

MHSM-6130

REVISION DATE: 01/2013