

NOTES:

1. ALL COPING CAP JOINTS MUST UTILIZE A 6" CONCEALED SPLICE PLATE.
2. ALL JOINTS ARE TO BE SEALED WITH AN APPROVED SEALANT ON TOP (BOTH SIDES OF JOINT) OF THE SPLICE PLATE. ALLOW A 1/4" GAP BETWEEN COPING SECTIONS.
3. LEAVE A 3/8" GAP ON THE INSIDE EDGE BETWEEN THE CLEAT AND THE WALL TO ALLOW THE COPING CAP TO SNAP INTO PLACE.
4. ALL FASTENERS MUST PENETRATE INTO THE NAILER A MINIMUM OF 1 1/2".
5. INSTALL THE COPING CLEAT USING FOUR GROMMETTED HEX HEAD SCREWS. FACE NAIL THE CLEAT USING TWO ROOFING NAILS.
6. INSTALL THE SPLICE PLATE BY LOCATING IT IN THE CENTER OF THE COPING JOINT. APPLY A BEAD OF AN APPROVED SEALANT ON BOTH SIDES OF THE TOP SURFACE OF THE SPLICE PLATE. DO NOT FASTEN THE SPLICE PLATE.
7. INSTALL COPING CAP OVER TOP SPLICE PLATE. BE SURE TO LEAVE A 1/4" GAP BETWEEN SECTIONS OF COPING TO ALLOW FOR EXPANSION AND CONTRACTION.
8. ALL JOINING SURFACES SUCH AS JOINTS, SPLICES, CORNERS, AND END CAPS MUST HAVE AN APPROVED SEALANT APPLIED TO THEM.

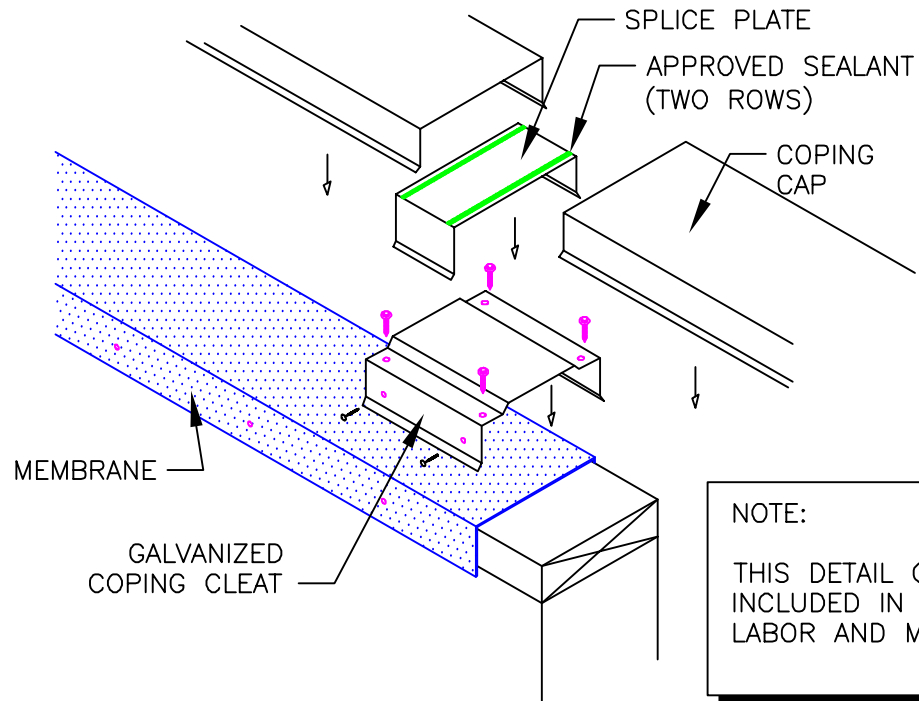
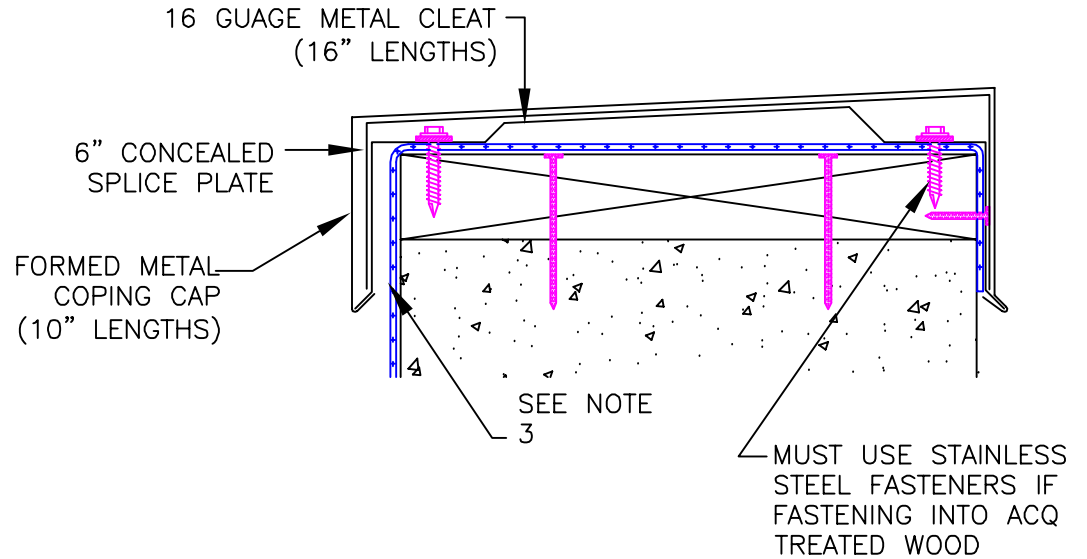

NOTE:

THIS DETAIL QUALIFIES TO BE INCLUDED IN ANY MULE-HIDE LABOR AND MATERIAL WARRANTY

**MULE-HIDE
PRODUCTS CO., INC.**

**MULE-HIDE PREMANUFACTURED
SNAP COPING
SYSTEMS:**

ALL MULE-HIDE SYSTEMS

DETAIL NO.:

MHSM-6054A

REVISION DATE: 01/2013