

NOTES:

1. DETAILS TO BE USED IN CONJUNCTION WITH STANDARD GUIDE SPECIFICATIONS CONTAINING REQUIREMENTS FOR NAILERS, INSULATION, SLIPSHEETS, ETC.
2. PVC EDGE SEALANT IS REQUIRED ON ALL CUT OR NON-ENCAPSULATED EDGES OF REINFORCED MEMBRANE. THIS INCLUDES FACTORY CUT MEMBRANE.
3. POSITION 2.4" SEAM PLATES 1/2" TO 1" FROM EDGE OF FIELD MEMBRANE.
4. SEAM PLATES CAN BE INSTALLED VERTICALLY.
5. IF A WOOD NAILER IS NOT PRESENT, THE FASTENER MUST ENGAGE THE STRUCTURAL ROOF DECK.
6. REFER TO MULE-HIDE UPLIFT RATINGS FOR APPROPRIATE FASTENER SIZE, AND SPACING.

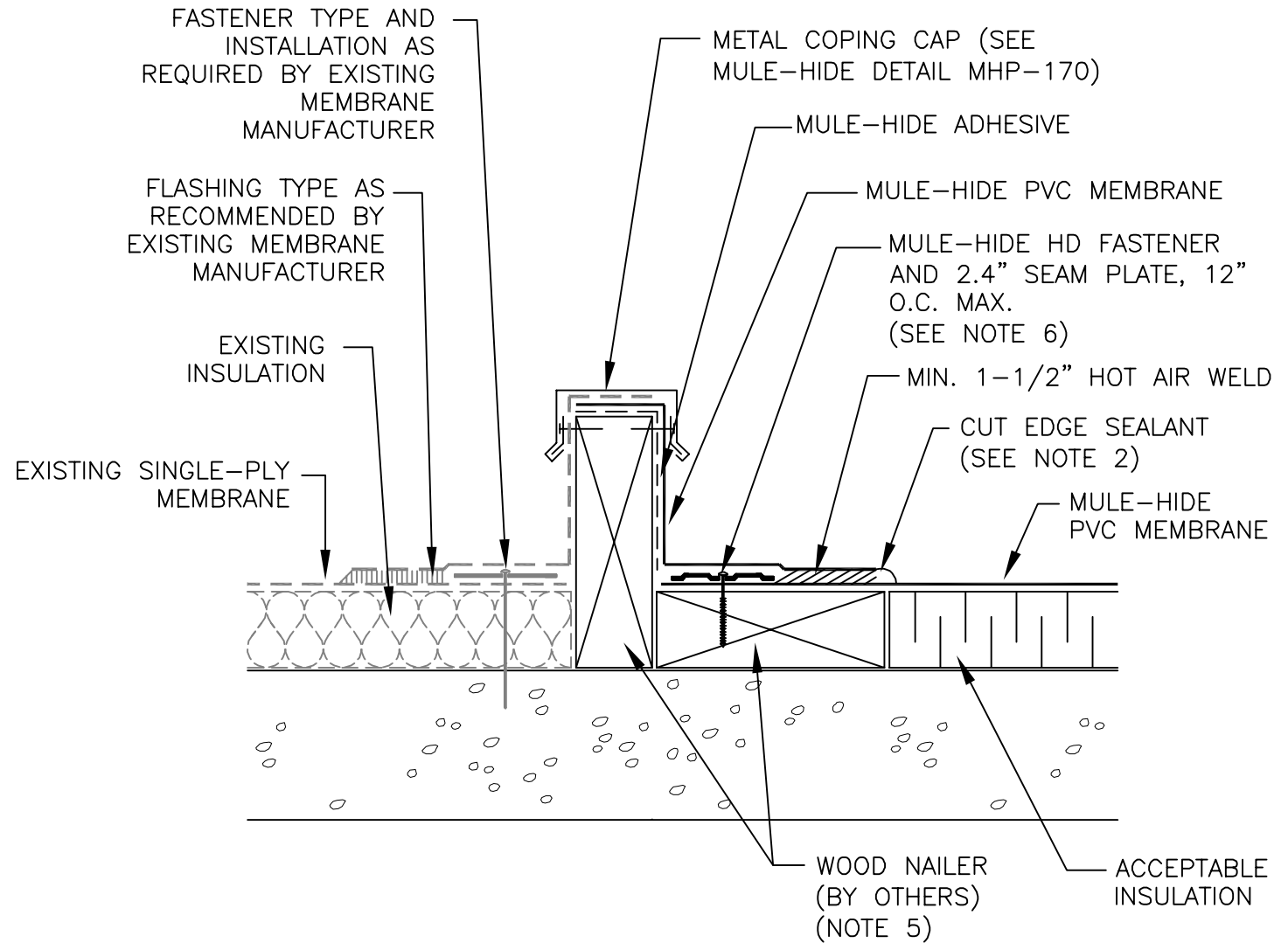

**MULE-HIDE
PRODUCTS CO., INC.
2010**

**TIE-IN TO EXISTING SINGLE-PLY
SYSTEMS:
ALL PVC**

**DETAIL NO:
MHP-160**